

KEY:

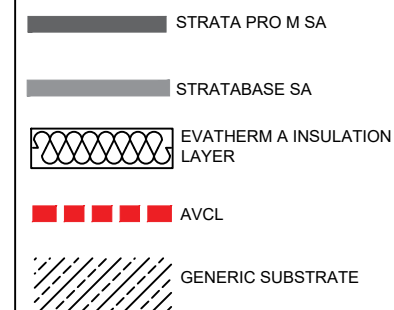

Notes:



Description:
INSULATED UPSTAND
TERMINATIONS

This is a standard generic detail and should be used for reference purposes only, and not form part of a specification document.

PRODUCT: STRATA PRO M SA

Drawing Date:
JUNE 2021

Scale:
NTS

Drawing No: PMSA_STD-04B	Rev. 2	Sheet 1 / 1
-----------------------------	-----------	----------------

The Strata Pro M SA System has been independently tested against wind uplift forces. **The Strata Pro M SA System can be used on projects where the calculated wind loadings are 2.5kPa or lower.**

Please contact ICB (Waterproofing) Ltd for wind loading calculations. Primer (EvaPrime SA) must be applied to each layer of the build up.