

#### KEY:

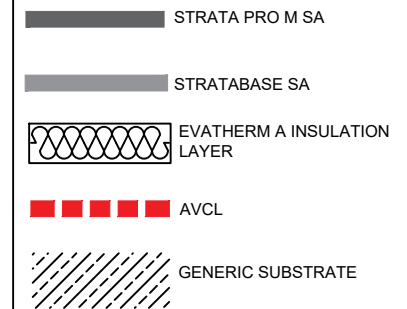

#### Notes:



#### Description:

FLAT ROOF TO PITCH

This is a standard generic detail and should be used for reference purposes only, and not form part of a specification document.

PRODUCT: STRATA PRO M SA

Drawing Date:  
JANUARY 2025

Scale:  
NTS

Drawing No: PMSA_STD-08	Rev.	Sheet 1 / 1
----------------------------	------	----------------

The Strata Pro M SA System has been independently tested against wind uplift forces. **The Strata Pro M SA System can be used on projects where the calculated wind loadings are 2.5kPa or lower.**

Please contact ICB (Waterproofing) Ltd for wind loading calculations. Primer (EvaPrime SA) must be applied to each layer of the build up.