

AVCL: StrataVap, StrataCon or StrataCon SA. - All SA membranes must be applied to a primed deck.

KEY:

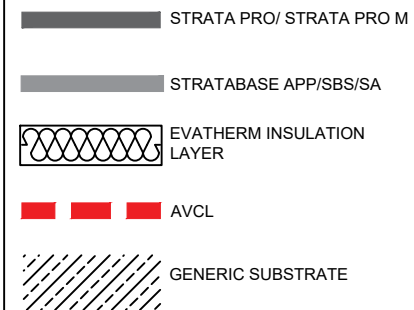

Notes:



Description:
STANDARD DETAIL FOR
PARAPET TERMINATION

This is a standard generic detail and should be used for reference purposes only, and not form part of a specification document.

PRODUCT:
STRATA PRO M

Drawing Date:
JUNE 2021

Scale:
NTS

Drawing No: STR PRO -09	Rev. 2	Sheet 1 / 1
----------------------------	-----------	----------------