

ALTERNATIVE DETAILS

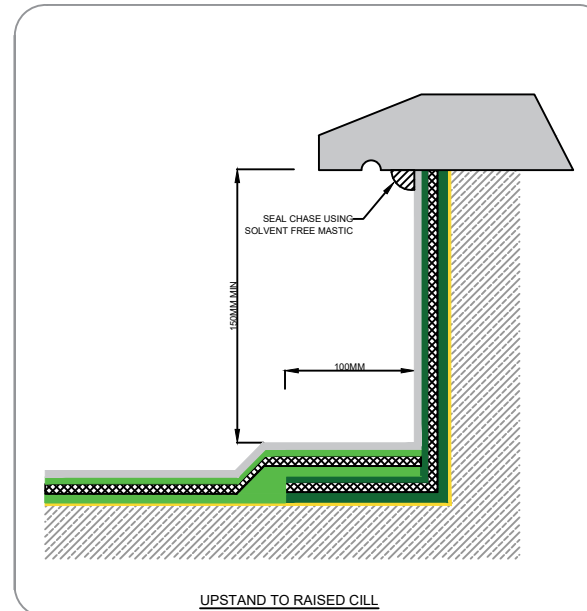
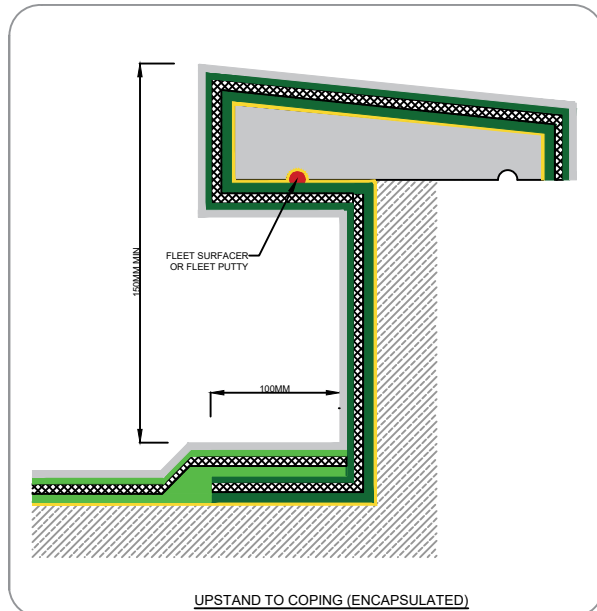
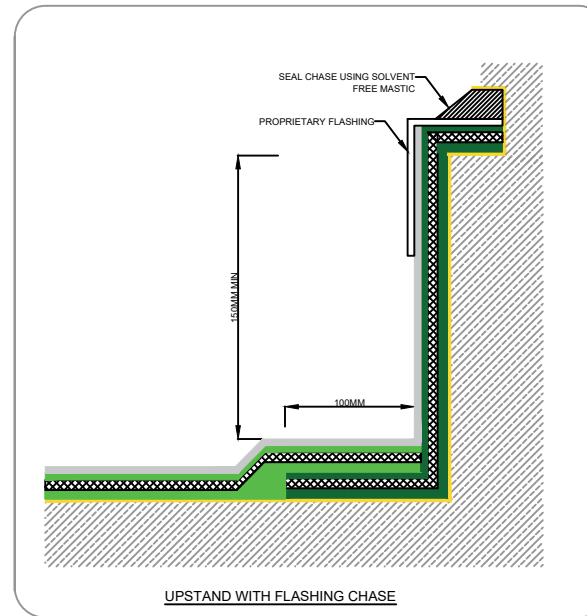
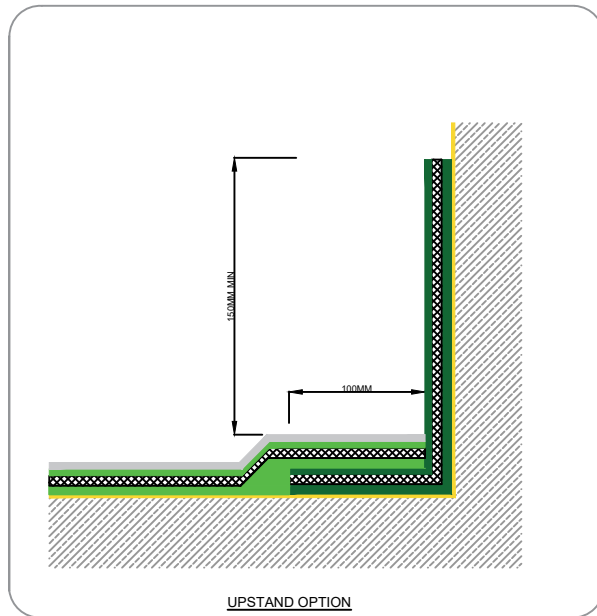

KEY:

	SEALER COAT (IF SPECIFIED)
	FLEET FLEECE
	FLEET COAT 30
	FLEET JUNCTION
	FLEET PRIMER (SEE MATRIX)
	GENERIC SUBSTRATE

Notes:

ALL FLEET LIQUID APPLIED WATERPROOFING SYSTEMS ARE TO BE INSTALLED BY AN ICB (WATERPROOFING) LTD APPROVED INSTALLER.

THE FLEET PRIMER MATRIX SHOULD BE CONSULTED FOR ALL PROJECTS TO ENSURE CORRECT PRIMER IS USED.

ADHESION TESTS MUST BE CARRIED OUT FOR ALL PROJECTS



Description:

DETAIL FOR UPSTANDS

This is a standard generic detail and should be used for reference purposes only, and not form part of a specification document.

PRODUCT:

FLEET
LIQUID APPLIED MEMBRANE

Drawing Date:

MAY 2021

Scale:

NTS

Drawing No:

FLEET STD -03

Rev.

2

Sheet

1 / 1