

SECUTOP COATED
METAL PROFILES
(SECUMET)
GUTTER EDGE
DETAIL
EXAMPLE

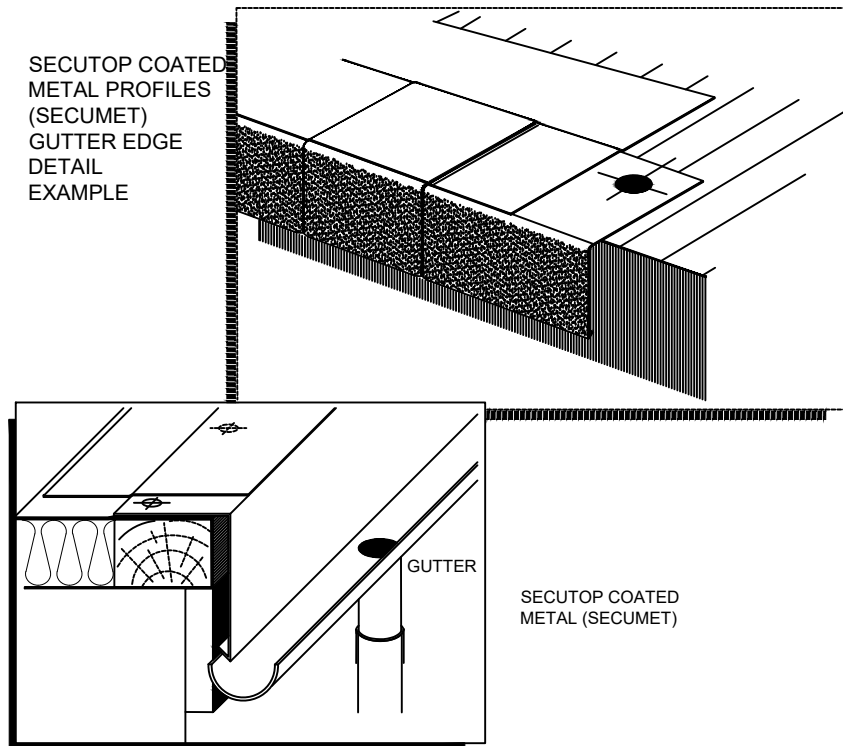

JOINT COVER PLATE
1.0 mm GALVANISED STEEL
(typically 100mm wide)

Due to expansion and contraction a gap of 3 to 5mm needs to be left between lengths, a non welded area of 20 to 25mm should be left at the centre of the joint covering tape. This can be achieved by masking the area before application. Joints should be kept away from internal and external corners and backed by a joint cover plate. Fixing centres are typically 200mm apart and approved fasteners must be used.

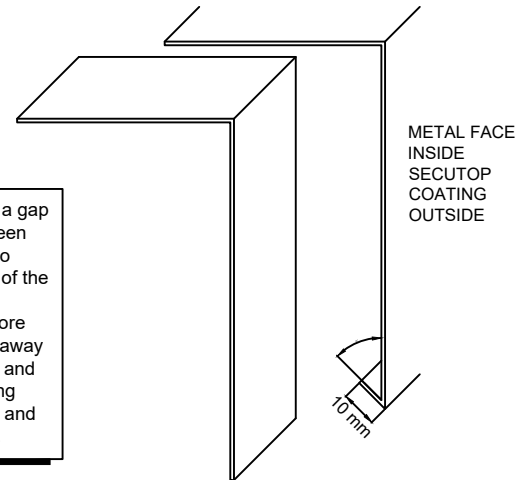

Notes:



Description:
STANDARD DETAIL FOR
SECUMET DRIP PROFILE DETAIL

This is a standard generic detail and should be used for reference purposes only, and not form part of a specification document.

PRODUCT:
SECUTOP SINGLE PLY

Drawing Date:
SEPTEMBER 2021

Scale:
NTS

Drawing No: SEC STD - 08	Rev. 2	Sheet 1 / 1
-----------------------------	-----------	----------------