

GLAZING SPECIFICATION:  
Sealed double glazing units comprising of:  
XX.X mm - XXXXX - Outer Pane  
16.0 mm - Argon Filled Air Gap - Cavity  
XX.X mm - XXXXX - Inner Pane

U value inner pane = 1.1W/m²K  
U value overall = 1.4W/m²K

FRAME:  
Frame, Fixings, Flashing etc. Polyester powder coated  
Standard RAL colour: RAL T.B.C.

ROOFLIGHT STANDARDS:  
All systems are tested at BRE / UKAS accredited stations & manufactured to:

BS EN 6375 - Weather Tightness  
BS EN 1026 - Air Permeability  
BS EN 1027 - Water Tightness of glass rooflights  
Class B to ACR(M)001:2014 Test for fragility of roofing assemblies  
CWCT TN66/67 (Class II) Non-Fragility tested for applicable rooflight

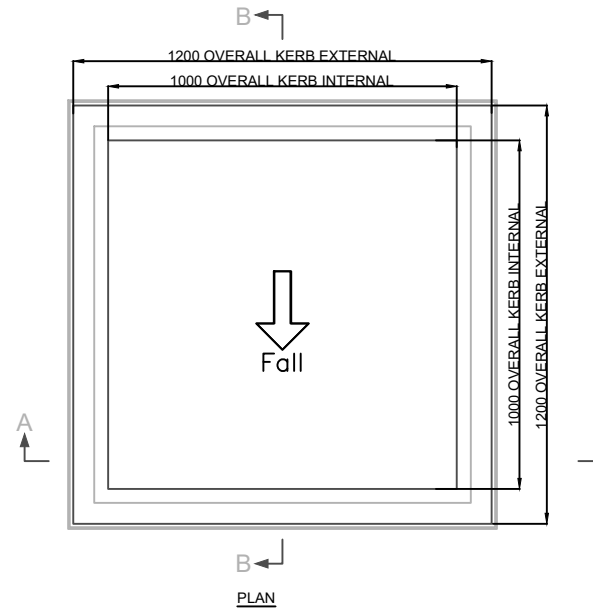

BLACK DOW CORNING  
791 WEATHERPROOF SEALANT  
HUECK GREY BACKING ROD  
ASH & LACY BLACK EDPM  
GLAZING TAPE WITH BLACK  
DOW CORNING 895 STRUCTURAL  
SEALANT BETWEEN  
PERIMETER GLAZING BAR  
BEDDED IN ASH & LACY BUTYL  
SEALANT FOR A CONTINUOUS  
AIR TIGHT SEAL  
UPSTAND BY OTHERS INDICATIVE,  
UPSTAND TO BE FULLY  
WEATHERED BY OTHERS PRIOR  
TO INSTALLATION OF ROOFLIGHT  
WEATHER SEAL  
APPLICABLE  
ASH & LACY FIXING  
INTERNAL FINISHES  
BY OTHERS

DETAIL A

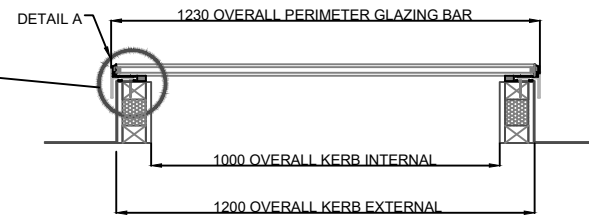

SECTION A - A

BLACK DOW CORNING  
791 WEATHERPROOF SEALANT  
HUECK GREY BACKING ROD  
ASH & LACY BLACK EDPM  
GLAZING TAPE WITH BLACK  
DOW CORNING 895 STRUCTURAL  
SEALANT BETWEEN  
PERIMETER GLAZING BAR  
BEDDED IN ASH & LACY BUTYL  
SEALANT FOR A CONTINUOUS  
AIR TIGHT SEAL  
UPSTAND BY OTHERS INDICATIVE,  
UPSTAND TO BE FULLY  
WEATHERED BY OTHERS PRIOR  
TO INSTALLATION OF ROOFLIGHT  
GLAZING  
WEATHER SEAL  
APPLICABLE  
ASH & LACY FIXING  
INTERNAL FINISHES  
BY OTHERS

DETAIL B

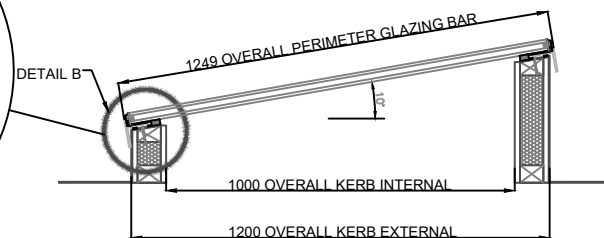

SECTION B - B

Notes:



Description:  
EVALITE MONOVISION ROOFLIGHT

This is a standard generic detail and should be used for reference purposes only, and not form part of a specification document.

PRODUCT:  
ALWITRA  
EVALON V/VSK

Drawing Date:  
JUNE 2021

Scale:  
NTS

Drawing No: EVA STD -7.4	Rev. 2	Sheet 1 / 1
-----------------------------	-----------	----------------