



ICB SolaBit

ICB SolaBit is a market-leading lightweight bitumen roof mounting available on projects designed by ICB Projects Ltd.

Developed for anchoring traditional photovoltaic modules on the roof, ICB SolaBit is installed to the visible Polymer-Bitumen waterproof layer using a Polymer-bitumen membrane band featuring a specific mixture designed to ensure outstanding adherence and cohesion properties. It is suitable for application on existing or new polymer-bitumen membranes.

ICB SolaBit removes the need for fixings that penetrate the waterproofing layer or ballasts, offering an easy to install and lightweight solution without compromising the roof's or waterproofing membrane's functionality and durability, making it ideal for new or retrofit systems.

SOLABIT FEATURES:

- Lightweight
- Non-penetrative installation
- No mechanical fixings that require penetrating the waterproofing layer or ballast required
- Suitable for flat or pitched roofs
- Suitable for existing and new Polymer-Bitumen Waterproof membranes

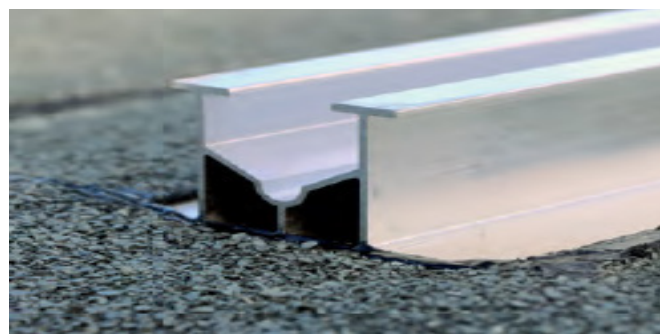
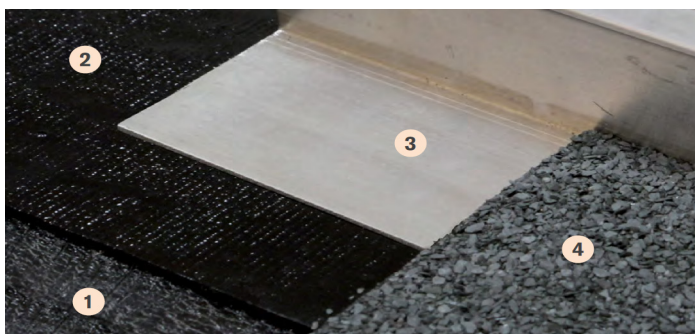

1. Polymer-bitumen membrane band for fixing onto the covering waterproofing layer.

2. Polymer-bitumen membrane band featuring a specific mixture developed to ensure outstanding adherence and cohesion properties over time. Fitted with a double removable silicone film.

3. Aluminium profile for fixing photovoltaic modules or technological installations. Its surface guarantees high adherence and resistance to uplift. The profile has a new structure with a central housing for accessories of connection to the base support.

4. Slated membrane band used to complete the fixing system and to protect the underneath layers from UV rays, fitted with a removable silicone film on the lower side.

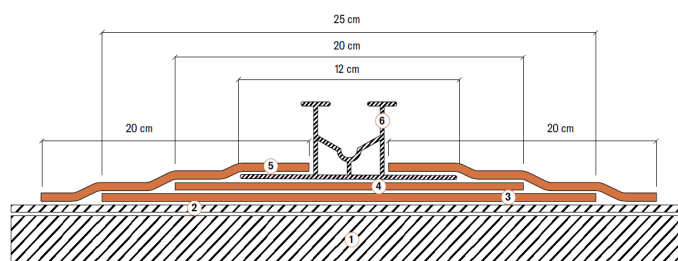

① Support	② Existing waterproofing / newly-made waterproofing	③ Band 25
④ Band 20	⑤ SolaBit	⑥ Band 20 Mineral